

**KEY PLAN**  
Scale: N.T.S.

**SUBJECT LANDS**

**NOTE:**  
THE POSITION OF POLE LINES, CONDUITS, WATERMANS, SEWERS AND UNDERGROUND AND ABOVE GROUND UTILITIES IS NOT NECESSARILY SHOWN ON THE CONTRACT DRAWINGS, AND WHERE SHOWN, THE ACCURACY OF THE POSITION OF SUCH UTILITIES AND STRUCTURES IS NOT GUARANTEED. BEFORE STARTING THE WORK THE CONTRACTOR SHALL INFORM HIMSELF OF THE EXACT LOCATION OF ALL UTILITIES AND STRUCTURES, AND SHALL ASSUME ALL LIABILITY FOR DAMAGE TO THEM.

THE CONTRACTOR MUST CHECK AND VERIFY ALL DIMENSIONS ON THE JOB AND REPORT ANY DISCREPANCY TO THE ARCHITECT/ENGINEERS BEFORE PROCEEDING WITH THE WORK.

ALL DRAWINGS AND SPECIFICATIONS ARE INSTRUMENTS OF SERVICE AND THE PROPERTY OF THE ENGINEER WHICH MUST BE RETURNED AT THE COMPLETION OF WORK.

THIS DRAWING IS NOT TO BE SCALED. CONTRACTOR TO USE DIGITAL FILES FOR LAYOUT PROVIDED BY ENGINEER. THIS PLAN MUST NOT BE USED TO SITE THE PROPOSED BUILDINGS.

THE APPROVAL OF THIS PLAN DOES NOT EXEMPT THE OWNER'S CONTRACTOR FROM OBTAINING, BUT NOT LIMITED TO THE FOLLOWING PERMITS: ROAD CUT, SEWER PERMITS, REDUCTION OF SERVICES, ENCROACHMENT AGREEMENTS, APPROACH APPROVAL PERMITS, ETC.

EXISTING TOPOGRAPHICAL INFORMATION SUPPLIED BY MACKAY, MACKAY & PETERS LIMITED, ONTARIO LAND SURVEYORS.  
BOUNDARY DATA DERIVED FROM INFORMATION FROM MACKAY, MACKAY & PETERS LIMITED, ONTARIO LAND SURVEYORS.

**BENCH MARK:**  
CITY OF BURLINGTON GEODETIC BENCHMARK No. 466  
ELEVATION = 83.334

**BEARING NOTE:**  
BEARINGS ARE ASTROMONIC AND ARE REFERRED TO THE WESTERLY LIMIT OF KING'S HIGHWAY N/S AS SHOWN ON PLAN 6R-1648L HAVING A BEARING OF N18°09'25"E.

**METRIC NOTE:**  
DISTANCES AND ELEVATIONS ON THIS PLAN ARE TYPICALLY SHOWN IN METRES AND CAN BE CONVERTED TO FEET BY DIVIDING BY 0.3048.

**THE REGIONAL MUNICIPALITY OF HALTON**

DESIGN OF SANITARY SERVICES AND WATER SERVICES APPROVED SUBJECT TO DETAIL CONSTRUCTION CONFORMING TO HALTON REGION STANDARDS AND SPECIFICATIONS, AND LOCAL APPROVAL FROM THE AREA MUNICIPALITY.

SIGNED: \_\_\_\_\_ DATED: \_\_\_\_\_  
LEGISLATIVE AND PLANNING SERVICES DEPARTMENT

**THE CORPORATION OF THE CITY OF BURLINGTON**

NO.	REVISIONS	DATE	BY
3	DRAFT PLAN AND PROFILE ISSUED FOR CITY REVIEW	MAR 28/19	AM
2	ISSUED FOR CLIENT REVIEW - WIP	MAR 26/19	AM
1	DRAFT PLAN & PROFILE SUBMISSION (FSR)	JAN 25/19	AM

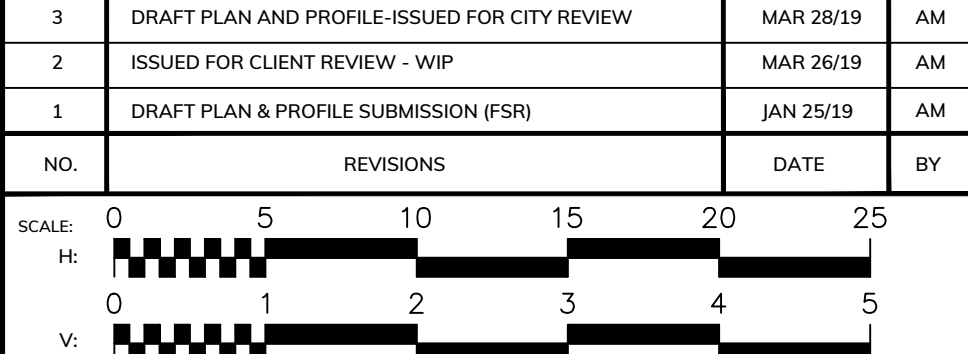

PROJECT: **BLUEWATER PLACE PROPOSED DEVELOPMENT**  
105 AVONDALE COURT  
143 BLUEWATER PLACE  
BURLINGTON, ONTARIO

**ODAN-DETECH**  
CONSULTING ENGINEERS

The Odan/Detech Group Inc. P: (905) 632-3811 F: (905) 632-3363  
6230 SOUTH SERVICE ROAD, BURLINGTON, ONTARIO, L7L 8K2

SCALE:	PROJ. NO.:	DATE:	DESIGN BY:
H 1:250 V 1:50	13215	JAN 2019	A.M.
13215 - BLUEWATER_401 - BLUEWATER PNP.DWG			DRAWN BY: J.M.K.
			CHECKED BY: M.H.H.
			APPROVED BY: J.K.
			DRAWN NO.: 1 OF 2

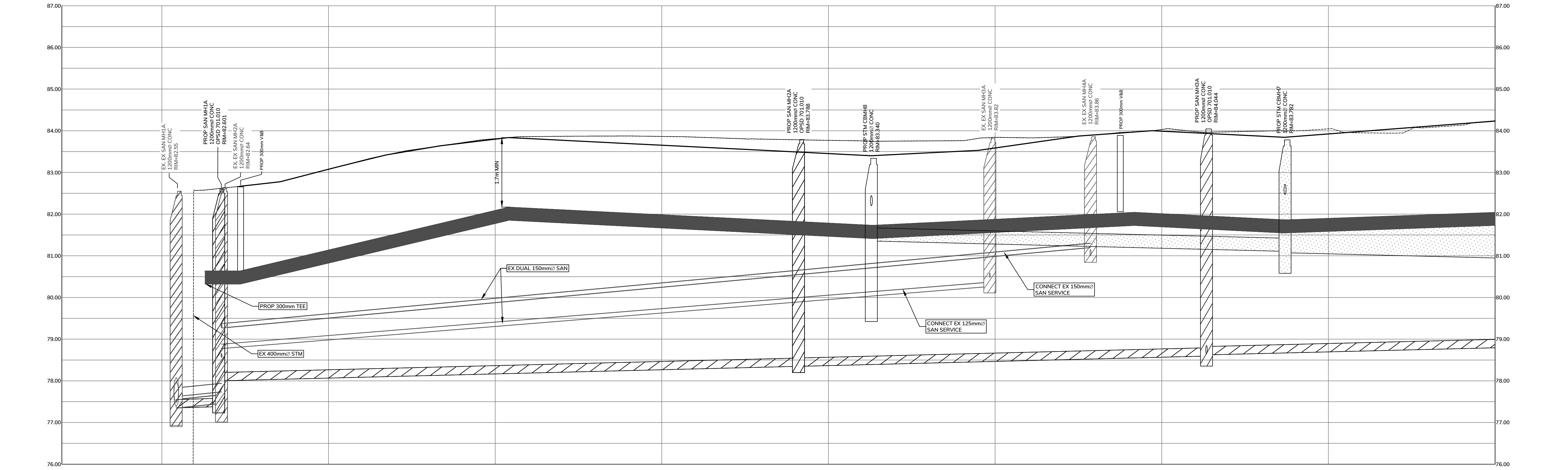

EXISTING ELEVATION	EXISTING SANITARY SEWER INVERT	PROPOSED SANITARY SEWER INVERT	PROPOSED WATERMAIN TOP OF PIPE ELEVATION
0+000 81.00	NE 77.48 SE 77.63 NW 77.38 SW	81.723	PROP 5.09m 200mm PVC SAN @ 0.50% SDR-35 ASTM D-3034 CSA B182.2 BEDDING AS PER OPSD 802.010
0+020 81.14		81.723	PROP 300mm PVC W/M DR-18 CSA B137.3 AWWA C900 BEDDING AS PER 802.010
0+040 83.81		81.723	PROP 69.58m 200mm PVC SAN @ 0.50% SDR-35 ASTM D-3034 CSA B182.2 BEDDING AS PER OPSD 802.010
0+060 83.06		81.782	PROP 300mm PVC W/M DR-18 CSA B137.3 AWWA C900 BEDDING AS PER 802.010
0+080 83.77		81.855	PROP 49.65m 300mm PVC STM @ 0.50% RUBBER GASKET JOINT, CSA A257.2 CLASS 100-D TYPE 50 CEMENT CLASS 'B' BEDDING AS PER OPSD 802.030
0+100 83.84	SW 80.27 NW 81.20 NE 81.20	81.855	PROP 37.16m 200mm PVC SAN @ 0.50% SDR-35 ASTM D-3034 CSA B182.2 BEDDING AS PER OPSD 802.010
0+120 84.03			PROP 300mm PVC W/M DR-18 CSA B137.3 AWWA C900 BEDDING AS PER 802.010
0+140 81.40			PROP 36.95m 750mm CONC STM @ 0.50% CLASS 100-D TYPE 50 CEMENT CLASS 'B' BEDDING AS PER OPSD 802.030