

NOTES TO CONTRACTOR:

- INSPECTION**
CONTRACTOR IS RESPONSIBLE FOR CONTACTING ENGINEER 48 HRS PRIOR TO COMMENCING WORK TO ARRANGE FOR INSPECTION. ENGINEER TO DETERMINE DEGREE OF INSPECTION AND TESTING REQUIRED FOR CERTIFICATION OF UNDERGROUND SERVICE INSTALLATION AS MANDATED BY ONTARIO BUILDING CODE DIVISION C, PART 1, SECTION 1.2.2, GENERAL REVIEW. FAILURE TO NOTIFY ENGINEER WILL RESULT IN EXTENSIVE POST CONSTRUCTION INSPECTION AT CONTRACTORS EXPENSE.
- CONFIRMATION OF EXISTING INVERTS**
72 HOURS PRIOR TO THE START OF CONSTRUCTION, THE CONTRACTOR IS TO LOCATE, EXPOSE AND VERIFY INVERTS OF EXISTING SEWERS AT CONNECTION POINTS AND REPORT FINDINGS TO MTE. SHOULD THE CONTRACTOR PROCEED WITHOUT COMPLETING THESE LOCATES, EXTRA COSTS RESULTING FROM DELAYS AND STANDBY TIME WILL NOT BE CONSIDERED.
- SHOP DRAWINGS**
CONTRACTOR TO PROVIDE SHOP DRAWINGS TO THE ENGINEER FOR REVIEW AND APPROVAL FOR ALL CHAMBERS AND STRUCTURES PRIOR TO THE START OF CONSTRUCTION AND PRIOR TO ORDERING ANY STRUCTURES AND PARTS.

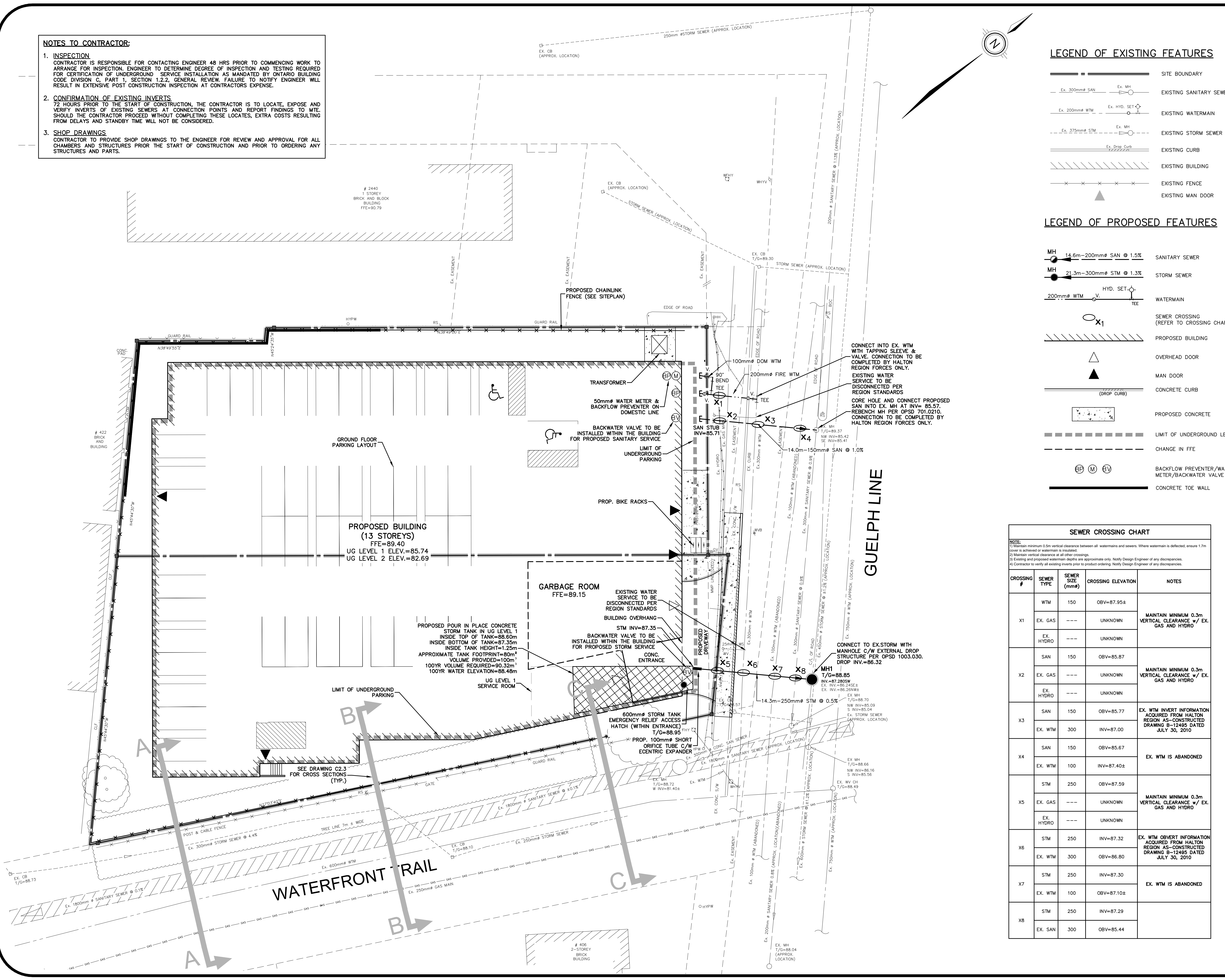

LEGEND OF EXISTING FEATURES

- SITE BOUNDARY
- Ex. 300mm ϕ SAN --- EXISTING SANITARY SEWER
- Ex. 200mm ϕ WTM --- EXISTING WATERMAIN
- Ex. 375mm ϕ STM --- EXISTING STORM SEWER
- Ex. Drop Curb --- EXISTING CURB
- EXISTING BUILDING
- EXISTING FENCE
- EXISTING MAN DOOR

LEGEND OF PROPOSED FEATURES

- MH 14.6m-200mm ϕ SAN @ 1.5% --- SANITARY SEWER
- MH 21.3m-300mm ϕ STM @ 1.3% --- STORM SEWER
- 200mm ϕ WTM --- WATERMAIN
- SEWER CROSSING (REFER TO CROSSING CHART)
- PROPOSED BUILDING
- OVERHEAD DOOR
- MAN DOOR
- CONCRETE CURB
- PROPOSED CONCRETE
- LIMIT OF UNDERGROUND LEVEL
- CHANGE IN FFE
- BACKFLOW PREVENTER/WATER METER/BACKWATER VALVE
- CONCRETE TOE WALL

SEWER CROSSING CHART

CROSSING #	SEWER TYPE	SEWER SIZE (mm)	CROSSING ELEVATION	NOTES
X1	WTM	150	OBV=87.95 \pm	MAINTAIN MINIMUM 0.3m VERTICAL CLEARANCE w/ EX. GAS AND HYDRO
	EX. GAS	---	UNKNOWN	
X2	EX. GAS	---	UNKNOWN	MAINTAIN MINIMUM 0.3m VERTICAL CLEARANCE w/ EX. GAS AND HYDRO
	EX. HYDRO	---	UNKNOWN	
X3	SAN	150	OBV=85.87	EX. WTM INVERT INFORMATION ACQUIRED FROM HALTON REGION AS-CONSTRUCTED DRAWING B-12495 DATED JULY 30, 2010
	EX. WTM	300	INV=87.00	
X4	SAN	150	OBV=85.67	EX. WTM IS ABANDONED
	EX. WTM	100	INV=87.40 \pm	
X5	STM	250	OBV=87.59	MAINTAIN MINIMUM 0.3m VERTICAL CLEARANCE w/ EX. GAS AND HYDRO
	EX. GAS	---	UNKNOWN	
X6	EX. GAS	---	UNKNOWN	EX. WTM OVERT INFORMATION ACQUIRED FROM HALTON REGION AS-CONSTRUCTED DRAWING B-12495 DATED JULY 30, 2010
	EX. HYDRO	---	UNKNOWN	
X7	STM	250	INV=87.32	EX. WTM IS ABANDONED
	EX. WTM	300	OBV=86.80	
X8	STM	250	INV=87.30	EX. WTM IS ABANDONED
	EX. WTM	100	OBV=87.10 \pm	
X8	STM	250	INV=87.29	
	EX. SAN	300	OBV=85.44	

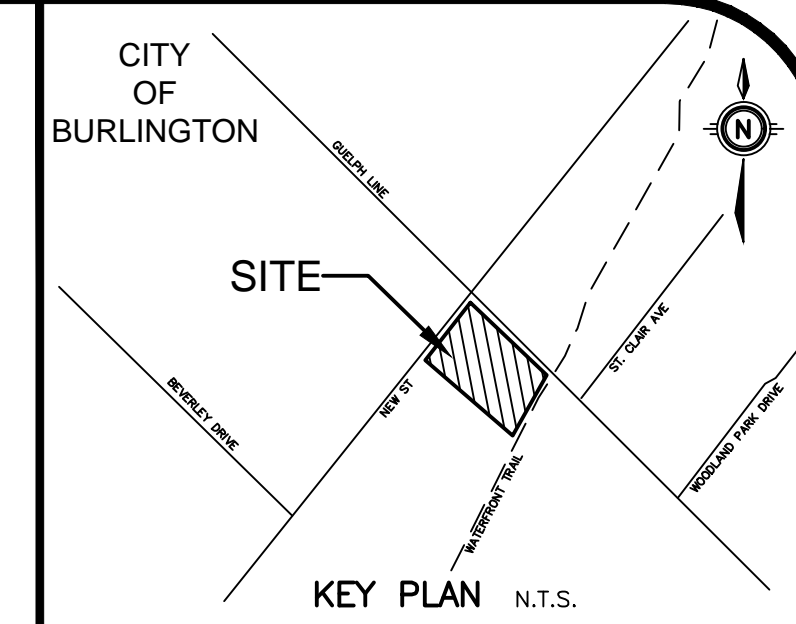

GEODETIC BM ELEV. = 80.809m
CITY OF BURLINGTON BENCHMARK No. 273
BRASS CAP IN TOP OF CURB AT THE NORTHERLY END OF THE RAMP LOCATED AT THE SOUTHEAST CORNER OF THE INTERSECTION OF LAKESHORE ROAD AND GUELPH LINE. THE MONUMENT IS LOCATED 5.5 METRES FROM THE END OF THE CURB RETURN ON THE SOUTHEAST CORNER OF THE INTERSECTION, 2.68 METRES FROM A NAIL IN THE FACE OF A WOODEN HYDRO POLE (TRAFFIC SIGNAL POLE) ON THE SOUTHEAST CORNER, AND 19.2 METRES FROM A WOODEN HYDRO POLE (TRAFFIC SIGNAL POLE) ON THE SOUTHWEST CORNER OF THE INTERSECTION.

SITE BENCHMARK ELEV. = m

NOTE TO CONTRACTOR :
DO NOT SCALE DRAWINGS.
CONTRACTORS MUST CHECK AND VERIFY ALL DIMENSIONS AND REPORT ANY DISCREPANCIES TO THE ENGINEER BEFORE PROCEEDING WITH THE WORK.
ALL DRAWINGS REMAIN THE PROPERTY OF THE ENGINEER AND SHALL NOT BE REPRODUCED OR REUSED WITHOUT THE ENGINEER'S WRITTEN PERMISSION.
THE OWNER/ARCHITECT/CONTRACTOR IS ADVISED THAT M.T.E. CONSULTANTS INC. CANNOT CERTIFY ANY COMPONENT OF THE SITE WORKS NOT INSPECTED DURING CONSTRUCTION. IT IS THE RESPONSIBILITY OF THE GENERAL CONTRACTOR TO NOTIFY M.T.E. CONSULTANTS INC. PRIOR TO COMMENCEMENT OF CONSTRUCTION TO ARRANGE FOR INSPECTION.

8.			
7.			
6.			
5.			
4.			
3.			
2.			
1.	ISSUED FOR ZBA	KRR	NOV.08/2019
No.	REVISION	BY	DATE

8.			
7.			
6.			
5.			
4.			
3.			
2.			
1.	ISSUED FOR ZBA	KRR	NOV.08/2019
No.	REVISION	BY	DATE

MTE
Engineers | Scientists | Surveyors
(905) 639-2552 www.mte85.com

LICENSED PROFESSIONAL ENGINEER
K.R. RAMSEWAK
10010092B
NOV 8 / 19
PROVINCE OF ONTARIO
NOT FOR CONSTRUCTION

CLIENT
WALDEMAR LIMITED
3410 SOUTH SERVICE ROAD, SUITE G5 BURLINGTON, ON
PROJECT
418 & 422 GUELPH LINE
13 STOREY APARTMENT BUILDING
418 & 422 GUELPH LINE BURLINGTON, ON

DRAWING
PRELIMINARY SITE SERVICING PLAN
Project Manager: K. RAMSEWAK Project No: 45401-100
Design By: RDZ Checked By: KRR
Drawn By: AJT/GXS Checked By: KRR
Surveyed By: OTHERS Drawing No.
Date: Feb.08/19
Scale: 1:200 Sheet 4 of 5