

**MAINTENANCE SCHEDULE**

- INSPECT AFTER EVERY MAJOR RAIN EVENT.
- INSPECT EVERY 3 WEEKS MINIMUM.
- SILTSACK SHOULD NEVER BE OVER HALF FULL.
- FULL BAG CAN BE REMOVED, DUMPED, CLEANED AND REUSED (TO REMOVE INSERT 25mm REBAR INTO REMOVAL FLAP PROCKETS) (TO DUMP INSERT 25mm REBAR INTO BOTH DUMPING STRAPS)

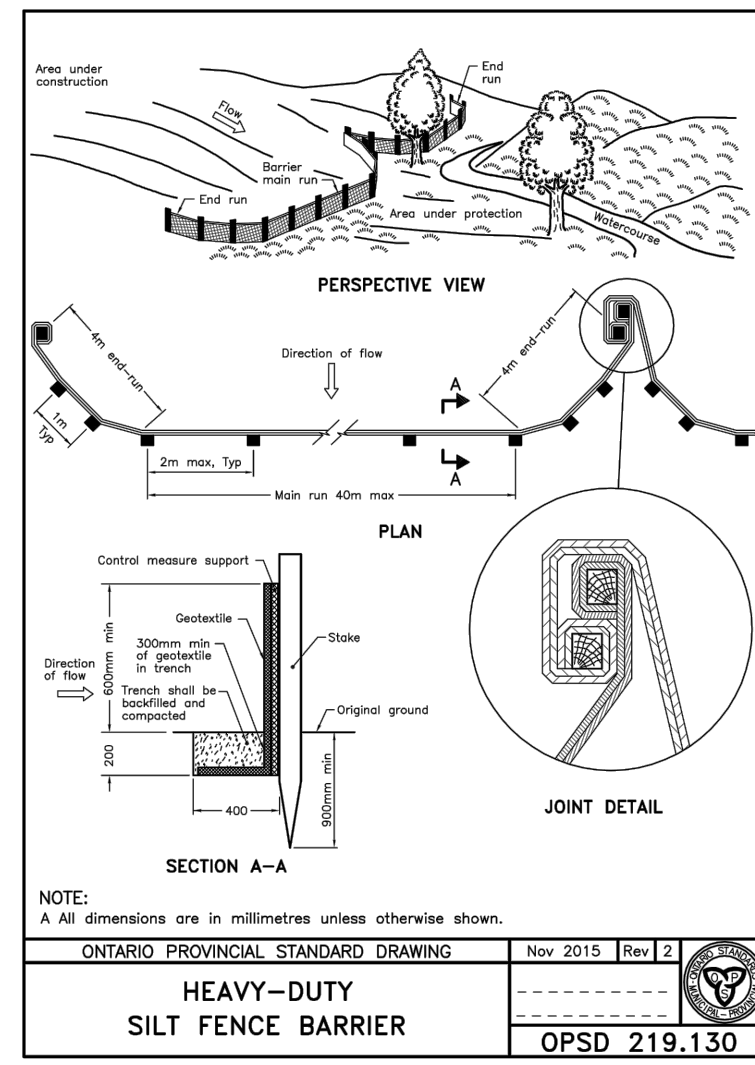

ONTARIO PROVINCIAL STANDARD DRAWING  
**HEAVY-DUTY SILT FENCE BARRIER**  
 OPSD 219.130

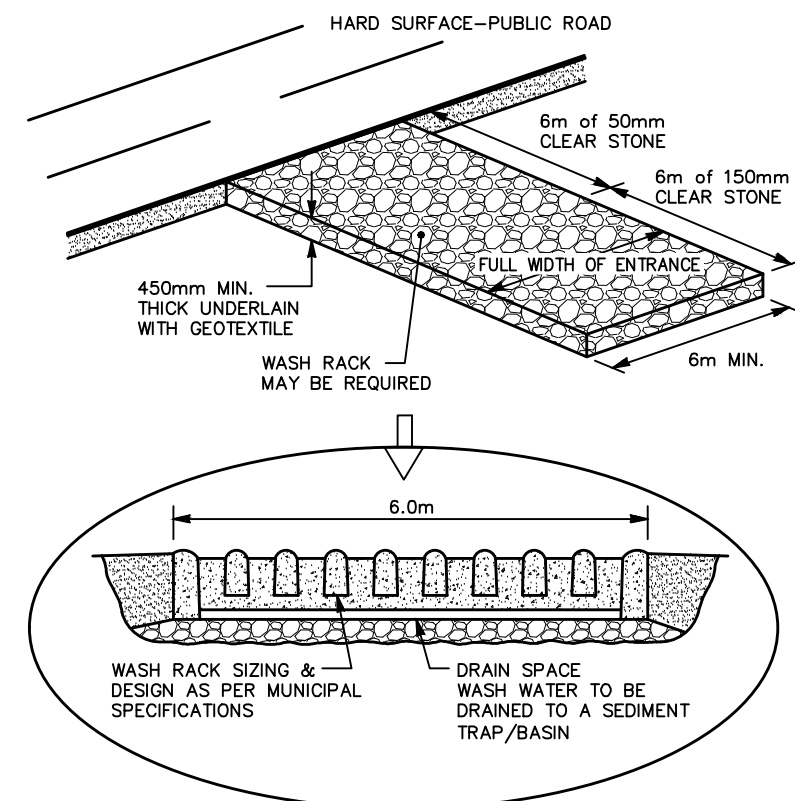

**CONSTRUCTION ACCESS DETAIL**  
 N.T.S.

**EROSION AND SEDIMENT CONTROL NOTES**

- CONTRACTOR TO INSTALL EROSION CONTROL MEASURES AS SHOWN PRIOR TO CONSTRUCTION AND MAINTAIN IN GOOD CONDITION UNTIL CONSTRUCTION IS COMPLETED AND ALL DISTURBED GROUND SURFACES HAVE BEEN RESTABILIZED EITHER BY PAVING OR RESTORATION OF VEGETATIVE COVER.
- ALL SEDIMENT CONTROL FENCING TO BE INSTALLED PRIOR TO ANY AREA GRADING, EXCAVATING OR DEMOLITION COMMENCING.
- EROSION CONTROL FENCING TO BE INSTALLED AROUND BASE OF ALL STOCKPILES. ALL STOCKPILES TO BE KEPT 2.5m MINIMUM FROM PROPERTY LINE.
- EROSION PROTECTION TO BE PROVIDED AROUND ALL STORM AND SANITARY MHS AND CBS.
- CATCH BASIN SEDIMENT CONTROL DEVICE, I.E. "SILTSACK" BY ACF ENVIRONMENT OR APPROVED EQUIVALENT, TO BE PLACED AS PER MANUFACTURER'S RECOMMENDATIONS (SEE DETAIL). REGULAR MAINTENANCE IS REQUIRED ("SILTSACK" SUMPS SHALL BE INSPECTED FOR SEDIMENT ACCUMULATION AND FILTER CLOTH BLOCKAGE ON A WEEKLY BASIS). THESE SEDIMENT TRAPS ARE NOT TO BE REMOVED UNTIL THE CURBS AND THE BOULEVARDS SODDED. SEDIMENT TRAPS SHALL ALSO BE PLACED AS PER DETAIL AT ALL CATCH BASIN LOCATIONS IN AREAS TO BE VEGETATED AND MAINTAINED UNTIL GROUND COVER IS ESTABLISHED.
- REGULAR MAINTENANCE FOR ALL CATCH BASINS (ON THE PUBLIC ROADWAY AND ON PRIVATE PROPERTY) AND INLET CHAMBERS IS REQUIRED (SEDIMENT TRAPS AND SUMPS SHALL BE INSPECTED FOR SEDIMENT ACCUMULATION, TRASH BUILDUP AND FILTER CLOTH BLOCKAGE ON A WEEKLY BASIS AND AFTER ANY MAJOR RAINFALL EVENT). ACCUMULATED SEDIMENT SHALL BE REMOVED BY MECHANICAL MEANS. FLOUSHING OF SEDIMENT INTO THE STORM SEWER SYSTEM IS PROHIBITED. IF STANDING WATER REMAINS IN THE CATCH BASIN 24 HOURS (MINIMUM) AFTER A STORM THEN CLEANING OR REPLACEMENT CLOTH IS REQUIRED.
- CONSTRUCTION ACCESS (MUD MAT) TO BE PROVIDED ON-SITE AT ALL LOCATIONS WHERE CONSTRUCTION VEHICLES EXIT THE SITE. CONSTRUCTION ACCESS (MUD MAT) SHALL BE A MINIMUM OF 6.0m WIDE, 12.0m LONG (LENGTH MAY VARY DEPENDING ON SITE LAYOUT) AND 0.5m DEEP AND SHALL CONSIST OF 200mm CLEAR STONE MATERIAL OR APPROVED EQUIVALENT. PROPOSED EROSION FENCING TO TIE INTO MUD MAT. CONTRACTOR TO ENSURE ALL VEHICLES LEAVE THE SITE VIA THE MUD MAT AND THAT THE MAT IS MAINTAINED IN A MANNER TO MAXIMIZE EFFECTIVENESS AT ALL TIMES.
- ADDITIONAL EROSION CONTROL MEASURES MAY BE REQUIRED AS SITE DEVELOPMENT PROGRESSES. CONTRACTOR TO PROVIDE ALL ADDITIONAL EROSION CONTROL STRUCTURES.
- EROSION CONTROL STRUCTURES TO REMAIN IN PLACE UNTIL ALL DISTURBED GROUND SURFACES HAVE BEEN RESTABILIZED.
- NO ALTERNATE METHODS OF EROSION PROTECTION SHALL BE PERMITTED UNLESS APPROVED BY THE ENGINEER AND THE LOCAL MUNICIPALITY'S DEPARTMENT OF PUBLIC WORKS.
- CONTRACTOR TO CLEAN ROADWAY AND SIDEWALKS OF SEDIMENTS RESULTING FROM CONSTRUCTION TRAFFIC FROM THE SITE EACH DAY.
- CONTRACTOR MUST REMOVE EROSION AND SEDIMENTATION FENCING PRIOR TO COMPLETION OF PROJECT. CONTRACTOR TO HAVE EROSION AND SEDIMENTATION FENCE INSPECTED WHEN VEGETATION HAS ESTABLISHED, BUT PRIOR TO FENCE BECOMING OVERGROWN. ENGINEER'S REPRESENTATIVE TO DETERMINE IF VEGETATION HAS REACHED THE CRITICAL POINT AND WILL THEN INSTRUCT CONTRACTOR TO REMOVE FENCE.
- ALL EROSION AND SEDIMENT CONTROL MEASURES SHALL BE VISUALLY INSPECTED AFTER EACH WORKING DAY AND MAINTAINED WHEN REQUIRED AS DIRECTED BY THE CONSULTANT AND TO THE SATISFACTION OF THE CITY/CONSERVATION AUTHORITY. THE CONSULTANT SHALL KEEP A DAILY RECORD OF INSPECTION, MAINTENANCE, ETC. AND PRESENT THE CITY WITH A COPY OF REPORT ON A MONTHLY BASIS.

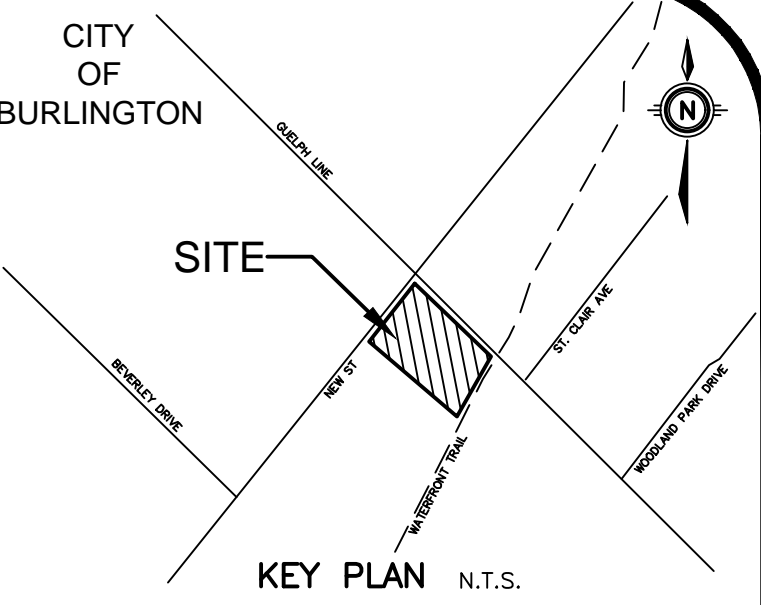

**GEODETIC BM** ELEV. = 80.809m  
 CITY OF BURLINGTON BENCHMARK No. 273  
 BRASS CAP IN TOP OF CURB AT THE NORTHERLY END OF THE RAMP LOCATED AT THE SOUTHEAST CORNER OF THE INTERSECTION OF LAKESHORE ROAD AND GUELPH LINE. THE MONUMENT IS LOCATED 5.5 METRES FROM THE END OF THE CURB RETURN ON THE SOUTHEAST CORNER OF THE INTERSECTION, 2.68 METRES FROM A NAIL IN THE FACE OF A WOODEN HYDRO POLE (TRAFFIC SIGNAL POLE) ON THE SOUTHWEST CORNER, AND 19.2 METRES FROM A WOODEN HYDRO POLE (TRAFFIC SIGNAL POLE) ON THE SOUTHWEST CORNER OF THE INTERSECTION.

**SITE BENCHMARK** ELEV. = m

**NOTE TO CONTRACTOR :**  
 DO NOT SCALE DRAWINGS.  
 CONTRACTORS MUST CHECK AND VERIFY ALL DIMENSIONS AND REPORT ANY DISCREPANCIES TO THE ENGINEER BEFORE PROCEEDING WITH THE WORK.  
 ALL DRAWINGS REMAIN THE PROPERTY OF THE ENGINEER AND SHALL NOT BE REPRODUCED OR REUSED WITHOUT THE ENGINEER'S WRITTEN PERMISSION.  
 THE OWNER/ARCHITECT/CONTRACTOR IS ADVISED THAT M.T.E. CONSULTANTS INC. CANNOT CERTIFY ANY COMPONENT OF THE SITE WORKS NOT INSPECTED DURING CONSTRUCTION. IT IS THE RESPONSIBILITY OF THE GENERAL CONTRACTOR TO NOTIFY M.T.E. CONSULTANTS INC. PRIOR TO COMMENCEMENT OF CONSTRUCTION TO ARRANGE FOR INSPECTION.

**TEMPORARY SILTSACK SILTATION CONTROL IN CB**  
 N.T.S.

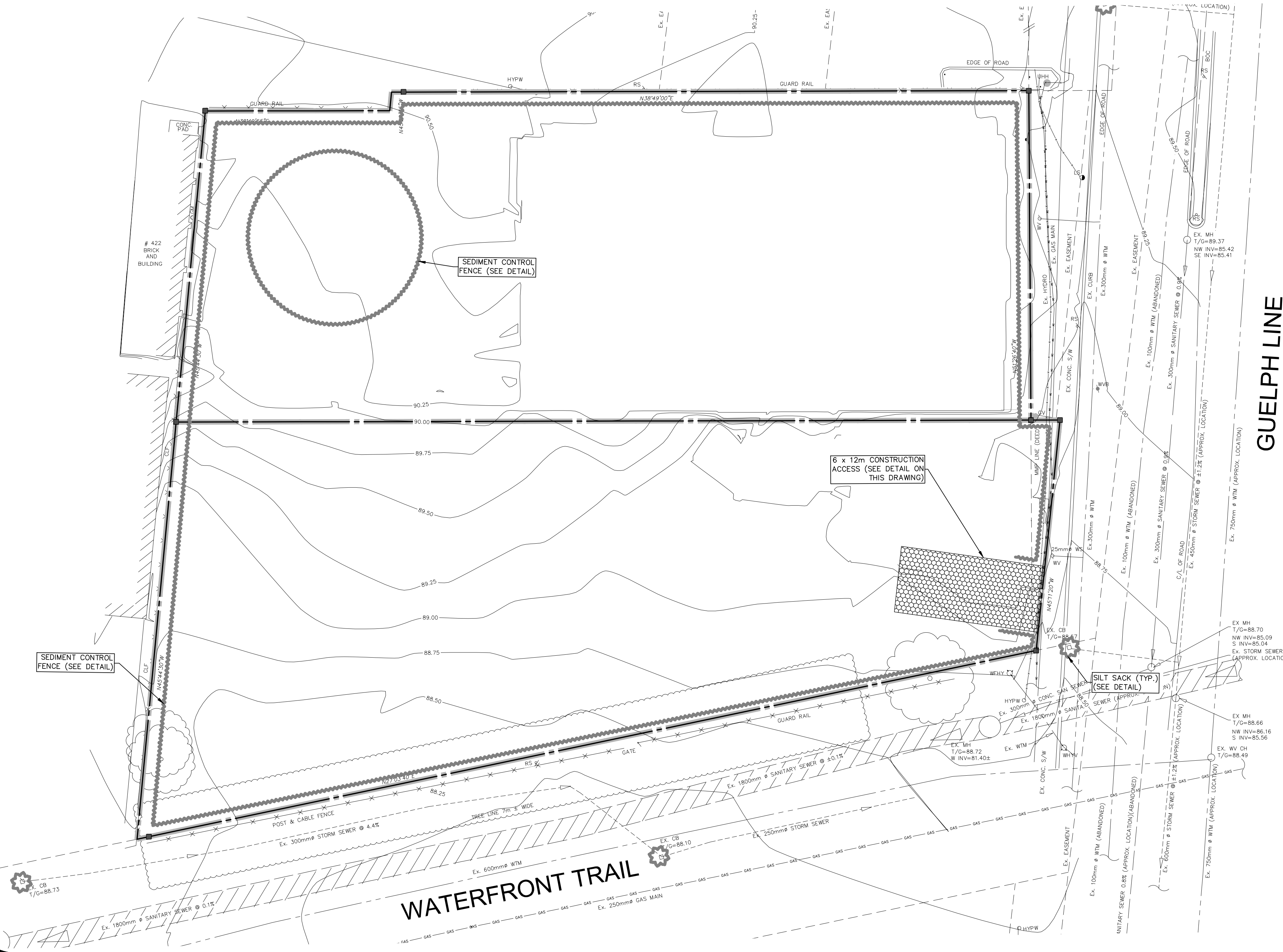

**LEGEND OF PROPOSED FEATURES**

- SEDIMENT CONTROL FENCE (SEE DETAIL)
- SILT SACK (SEE DETAIL)
- CONSTRUCTION ACCESS (SEE DETAIL)

**NOTES TO CONTRACTOR:**

- INSPECTION**  
 CONTRACTOR IS RESPONSIBLE FOR CONTACTING ENGINEER 48 HRS PRIOR TO COMMENCING WORK TO ARRANGE FOR INSPECTION. ENGINEER TO DETERMINE DEGREE OF INSPECTION AND TESTING REQUIRED FOR CERTIFICATION OF UNDERGROUND SERVICE INSTALLATION AS MANDATED BY ONTARIO BUILDING CODE DIVISION C, PART 1, SECTION 1.2.2, GENERAL REVIEW. FAILURE TO NOTIFY ENGINEER WILL RESULT IN EXTENSIVE POST CONSTRUCTION INSPECTION AT CONTRACTORS EXPENSE.
- CONFIRMATION OF EXISTING INVERTS**  
 72 HOURS PRIOR TO THE START OF CONSTRUCTION, THE CONTRACTOR IS TO LOCATE, EXPOSE AND VERIFY INVERTS OF EXISTING SEWERS AT CONNECTION POINTS AND REPORT FINDINGS TO MTE. SHOULD THE CONTRACTOR PROCEED WITHOUT COMPLETING THESE LOCATES, EXTRA COSTS RESULTING FROM DELAYS AND STANDBY TIME WILL NOT BE CONSIDERED.
- SHOP DRAWINGS**  
 CONTRACTOR TO PROVIDE SHOP DRAWINGS TO THE ENGINEER FOR REVIEW AND APPROVAL FOR ALL CHAMBERS AND STRUCTURES PRIOR THE START OF CONSTRUCTION AND PRIOR TO ORDERING ANY STRUCTURES AND PARTS.

8.		
7.		
6.		
5.		
4.		
3.		
2.		
1.	ISSUED FOR ZBA	KRR NOV.08/2019
No.	REVISION	BY DATE



(905) 639-2552 www.mte85.com



NOT FOR CONSTRUCTION

**CLIENT**  
**WALDEMAR LIMITED**  
 3410 SOUTH SERVICE ROAD, SUITE G5 BURLINGTON, ON  
**PROJECT**  
 418 & 422 GUELPH LINE  
 13 STOREY APARTMENT BUILDING  
 418 & 422 GUELPH LINE BURLINGTON, ON

**DRAWING**  
**EROSION AND SEDIMENT CONTROL PLAN**

Project Manager	K. RAMSEWAK	Project No.	45401-100
Design By	ALP	Checked By	KRR
Drawn By	GXS/RNC	Checked By	ALP
Surveyed By	OTHERS	Drawing No.	C1.2
Date	Feb.08/19	Scale	1:200
Scale	1:200	Sheet	2 of 5