

CONTRACTOR MUST CHECK AND VERIFY ALL DIMENSIONS AND JOB CONDITIONS BEFORE PROCEEDING WITH WORK
 ALL DRAWINGS MAY BE SUBJECT TO CHANGE DUE TO COMMENTS FROM MUNICIPAL DEPARTMENTS AND OTHER AGENCIES WITH AUTHORITY
 ALL DRAWINGS AND SPECIFICATIONS ARE THE PROPERTY OF THE ARCHITECTS AND MUST BE RETURNED AT THE COMPLETION OF THE WORK
 THE CONTRACTOR WORKING FROM DRAWINGS NOT SPECIFICALLY MARKED FOR CONSTRUCTION MUST ASSUME FULL RESPONSIBILITY AND BEAR COSTS FOR ANY CORRECTIONS OR DAMAGES RESULTING FROM HIS OR HER WORK

KEY TO DETAIL LOCATION
 No. DETAIL NUMBER
 No. DRAWING SHEET NUMBER

DRAWING SETS ISSUED	No.	DATE (DD.MM.YY)	BY
FOR CLIENT REVIEW	J	29.07.2019	WH
FOR CLIENT REVIEW	K	30.07.2019	WH
ISSUED FOR REVIEW	L	18.10.2019	GA
PER OP/ZONING COMMENTS	Z	08.11.2019	GA

ALL PREVIOUS ISSUES OF THIS DRAWING ARE SUPERSEDED

REVISIONS TO DRAWING	No.	DATE (DD.MM.YY)	BY
NOT FOR CONSTRUCTION			

BUILDING PERMIT NUMBER:
 NOT FOR CONSTRUCTION WITHOUT PERMIT

KNYMH
 ARCHITECTURE • SOLUTIONS

KNYMH INC.
 1006 SKYVIEW DRIVE • SUITE 101
 BURLINGTON, ONTARIO • L7P 0V1
 T 905.639.6595
 F 905.639.0394
 www.knymh.com info@knymh.com

THIS DOCUMENT IS A PRELIMINARY AND MAY BE USED FOR REGULATORY APPROVAL. PERMIT CONSTRUCTION SHALL BE FOR USE BY CLIENTS, SUBCONTRACTORS, OWNER AND CONTRACTORS TO PROVIDE FEEDBACK TO THE ARCHITECT. THIS DOCUMENT IS NOT TO BE USED FOR CONSTRUCTION.

418&422 GUELPH LINE,
 BURLINGTON, ON
 CONCEPT I

DRAWING SHEET TITLE:
UNDERGROUND - LEVEL 2

DRAWING SCALE: AS NOTED	PROJECT NUMBER: 18006
DRAWN BY: WH	CHECKED BY: PM
DRAWING VERSION: 001	DRAWING SHEET NUMBER: UG2
PLOT DATE: November 8, 2019	

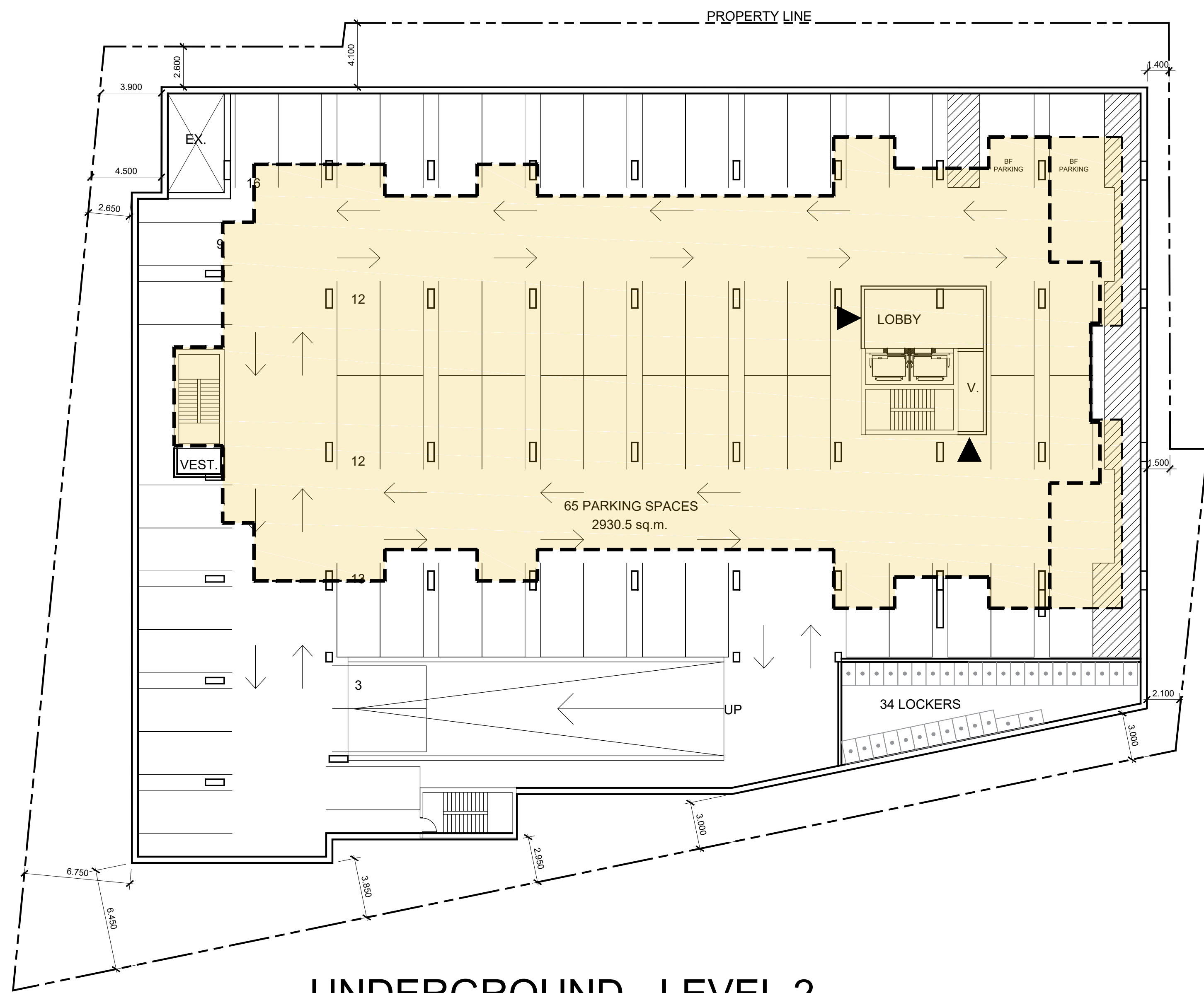

UNDERGROUND - LEVEL 2
 *CONCEPTUAL PLAN - ALLOW FOR DEVIATIONS

1 PLAN
 UG2 UNDERGROUND L2
 1:200

TIMESTAMP: 2019-11-08 10:04:06 PM FILEPATH: C:\2019\18006 - Water Capital - Guelph Line Condos\4 Drawings\4.03 Schematic Design\Concept 1\18006 Water Capital - Site Plan 2019-11-07 - CH-3.dwg